

CONTRACTOR TO USE STAINLESS STEEL FLATHEAD TAPCON SCREWS (3 PER SIDE) TO FASTEN PVC ANGLE IRON TO THE CONCRETE WALLS.  
 CARE SHALL BE TAKEN WHEN SETTING THE BOX FOR ELEVATION AND LOCATION.  
 THE VILLAGE WILL PROVIDE THE CONTRACTOR WITH THE TREE GRATE, FRAME, AND STRUCTURAL SOIL. THE VILLAGE WILL SUPPLY AND INSTALL THE TREE AT A LATER DATE.

TREE GRATE SHALL BE POLY-GRATE II, PART #T-SB44, 4'x4' SQUARE WITH BLACK PVC ANGLE FRAME, OR EQUAL. TREE GRATE SHALL BE INSTALLED PRIOR TO OPENING OF WALK. SHIM TREE GRATING TOP AND ANGLE IRON WITH NYLON SHIMS. GRATE AND ANGLE IRON TO BE FLUSH WITH TOP OF PAVERS. A TEMPORARY PLUG SHALL BE SECURED TO THE GRATE CENTER HOLE. FLUSH WITH TOP OF GRATE, SUITABLE FOR PEDESTRIAN TRAFFIC UNTIL TREE IS PLANTED. PAYMENT FOR TREE SHALL BE MADE TO CONTRACTOR UPON TREE INSTALLATION. TEMPORARY PLUG INCLUDED IN UNIT PRICE BID FOR ITEM SPECIAL TREE GRATE, EACH.

**SPECIFICATIONS FOR RECYCLED PLASTIC TREE GRATES**

- TREE GRATES SHALL BE OF POST-INDUSTRIAL RECYCLED HIGH-DENSITY POLYETHYLENE RESINS CONFORMING TO ASTM D-638.
- GRATE PATTERN SHALL COMPLY WITH A.D.A. GUIDELINE FOR EQUAL ACCESS. GRATE COLOR SHALL BE BLACK. GRATE DIMENSIONS SHALL BE 47.75" x 47.75" WITH A DEVIATION TOLERANCE OF 0.25" WHEN ASSEMBLED. GRATE SHALL BE 2" THICK.
- GRATES SHALL BE MANUFACTURED TRUE TO PATTERN, OF UNIFORM QUALITY AND SIZE, AND FREE FROM DEFECTS. SURFACE SHALL BE SMOOTH, FREE FROM SHARP EDGES. GRATES SHALL BE MANUFACTURED USING INJECTION MOLD.
- GRATE SHALL CONTAIN 2% BY WEIGHT CARBON BLACK UV INHIBITOR.
- TREE GRATE HALVES SHALL BE JOINED TOGETHER WITH TEMPER-RESISTANT BOLT ASSEMBLY PACKAGE AS PROVIDED BY THE MANUFACTURER, OR APPROVED EQUAL. PACKAGE TO CONSIST OF 6 EACH 3/8 16x1-1/4 BUTTON HEAD SOCKET CAP SCREW, STAINLESS STEEL; 3/8 USS FLAT WASHER, STAINLESS STEEL; AND 3/8 16 TUFF NUT, STAINLESS STEEL.
- TREE GRATES INSTALLED SHALL NOT BE SECURED TO THE CONCRETE STRUCTURE. IF NEEDED TO BE SECURED THIS WILL BE DONE BY THE VILLAGE OF ADA.

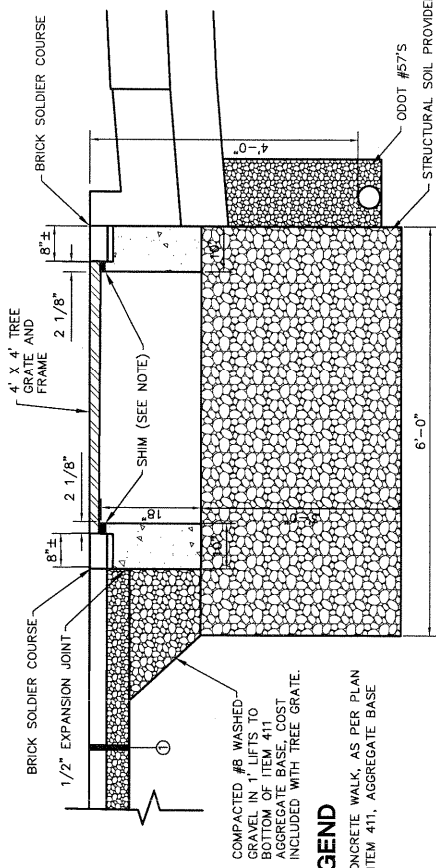

**TREE GRATE DETAIL**

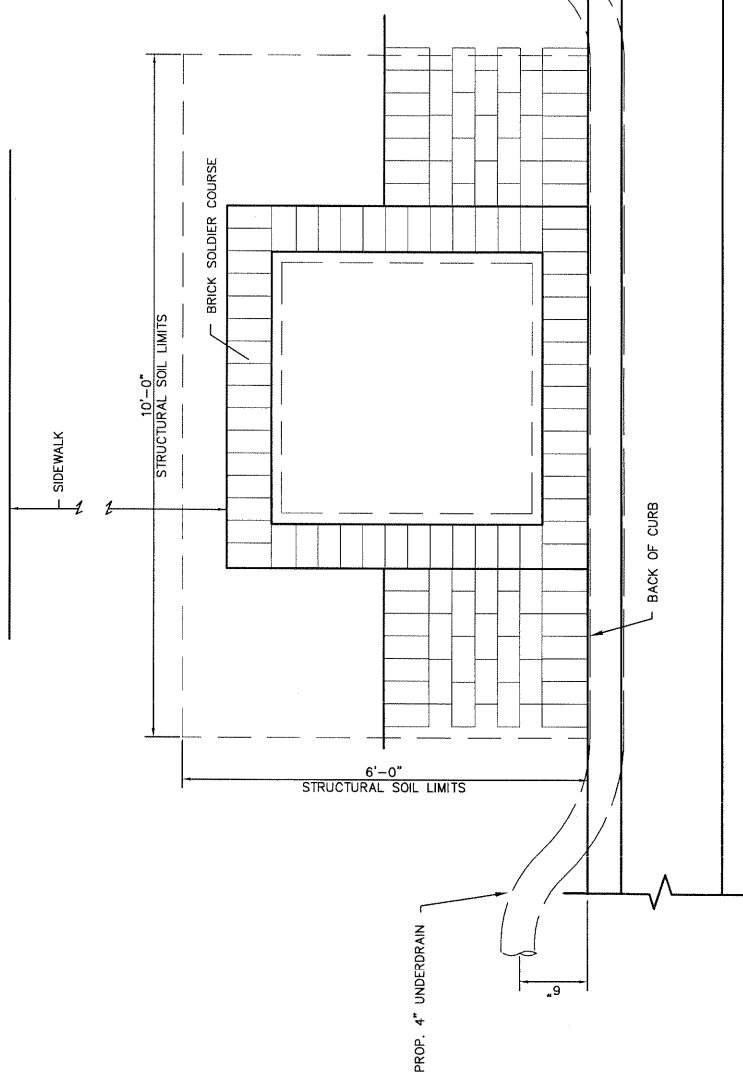

**LEGEND**

- ① ITEM 608 - 5" CONCRETE WALK, AS PER PLAN WITH 5-3/4" OF ITEM #11, AGGREGATE BASE